



Fonderie Sime S.p.A. - Via Garbo, 27 - 37045 Legnago (VR) - [www.sime.it](http://www.sime.it)  
 Tribunale Verona 13531 - R.E.A. VR 171357 - C.C.P. 19423375 - N° Mecc. VR 014435  
 Capitale Sociale Euro 5.521.200 int. versato - Codice Fiscale/Partita IVA n. IT 01275930236

Comfort Ambiente - Via Garbo, 27 - 37045 Legnago (VR)

Tel +39 0442 631111 - Fax Servizio Commerciale: Italia +39 0442 631291 - Estero +39 0442 631293

Fax Servizio Tecnico +39 0442 631292 - Fax Ufficio Acquisti +39 0442 631292 - Fax Amministrazione +39 0442 631336

8112622 MINI 11 LN OF ERP

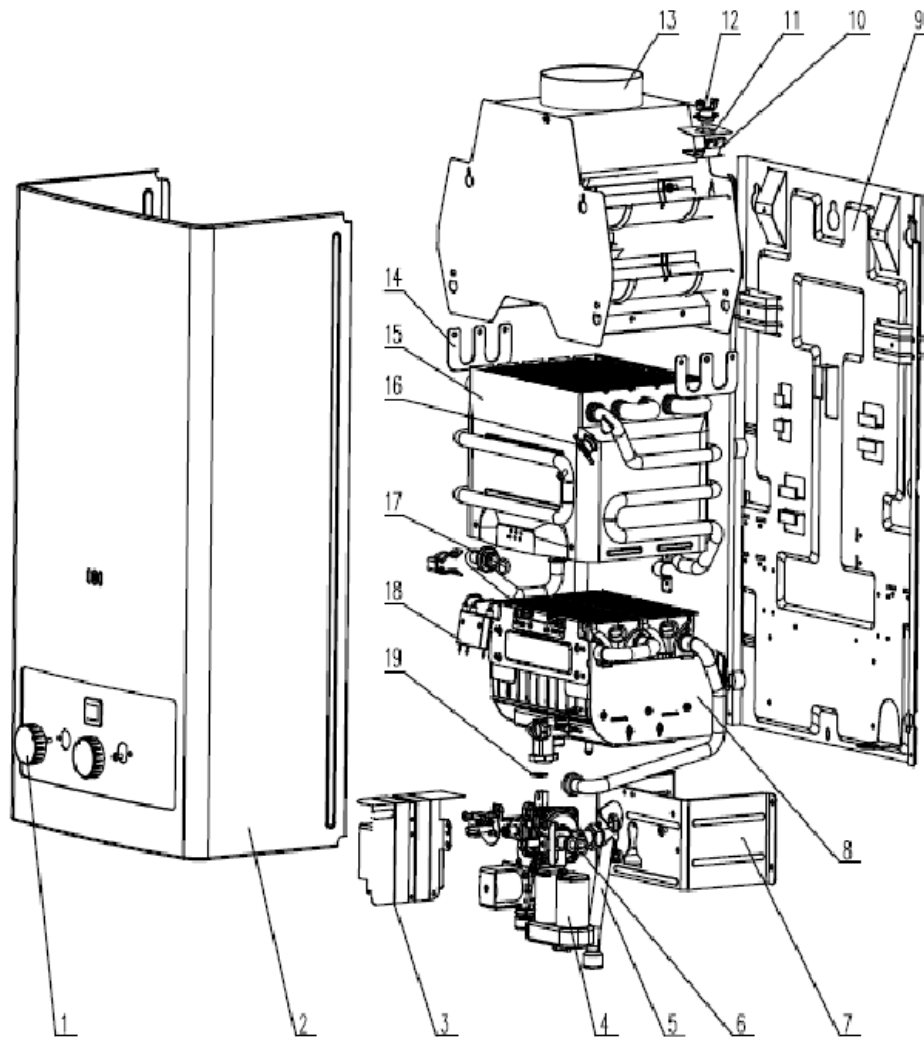

Position	Code	Description	Where used	Advised parts
001	6329550	Knob		
002	6329551	Mantle assy		
003	6329552	Pulse igniter assy		
004	6329553	Battery box assy		
005	6329554	Water/gas link. valve assy-met		
006	6329556	O-ring		
007	6329557	Bracket x water/gas link.valve		
008	6329559	Burner assy met		
009	6329560	Bottom case		
010	6329561	Thermostat fixing plate		
011	6329562	Thermostat heat shield		
012	6329563	Smoke thermostat		
013	6329564	Exhaust fume collecting hood		
014	6329565	Mounting plate		
015	6329566	Heat exchanger assy		
016	6329567	Safety thermostat		
017	6329568	O-ring		
018	6329569	Ignition pin components		
019	6329570	Gas tube sealing ring		

- A = Spare parts for minimum fittings
- A+B = Spare parts for basic safety fittings
- A+B+C = Spare parts for extended safety fittings